

accessories

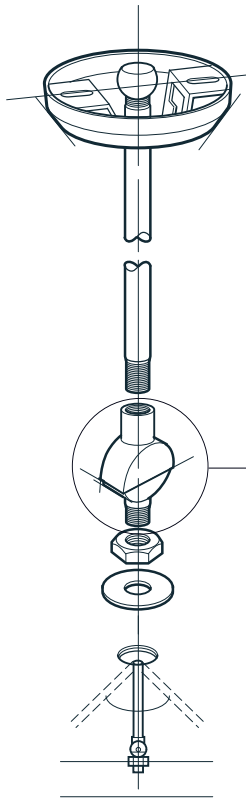

SSC-___ swivel-top stem hanger set

Standard equipment includes canopy, swivel bracket, ball swivel, $\frac{3}{8}$ " I.P.S. stem (specify length) and lock nut. Longitudinal body sway hanger optional.

BSH longitudinal body sway hanger (one per stem)

SCH sliding clamp hanger – stem suspension

Specify for single-unit stem suspension or for continuous-row installations where varied or unusual stem locations are desired. For use with P-102 and P-200 series luminaires.

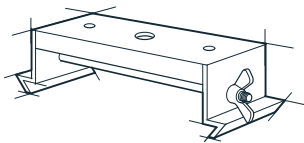

AMP adjustable mounting plate

Available with the PRU-5, LEGEND, and P-25 series, allows fixtures to accommodate existing or variable mounting and feed locations.

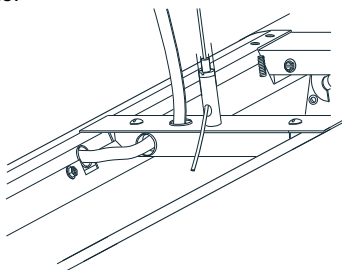

REP reflector end plate

Two per row will be supplied when row-mounting is specified. For use with P-200 and P-222 series luminaires.

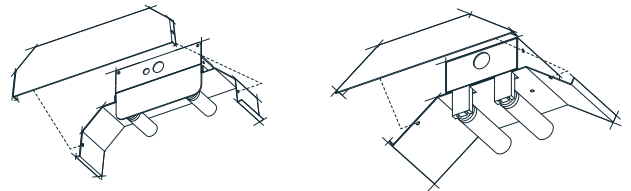

CHJ chain hanger joiner – square side

The CHJ serves a two-fold purpose of joining two fixtures in tandem and as a hanger when chain suspension is desired. **Earthquake tested and approved by the City of Los Angeles.** For use with P-101, P-122, P-102, P-200 and P-222 series luminaires.

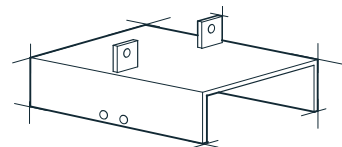

MSD hanger hooks

Use in conjunction with the CHJ chain hanger, when chain suspension is desired. For use with P-101, PSM-101, P-122, P-102, P-142, PL-140, P-200 and P-222 series luminaires.

